

**INSTRUCTIONS FOR CONVERTING
SureFlo® AUTOMATIC COUNTER-MOUNTED SOAP DISPENSERS
B-824 LIQUID AND B-828 FOAM FROM BATTERIES TO AC POWER USING THE MULTI ADAPTER**

WITH 824-201, AC ADAPTER KIT (DOES NOT INCLUDE INTERCHANGEABLE PLUGS FOR U.K., EUROPE, AND AUSTRALIA.
IF NEEDED, ORDER ASSORTMENT PLUG KIT, PART. NO. 824-202 TO FIT CORRESPONDING PLUG)

Bobrick Part Number 824-201, AC Adapter Kit includes:

- Distributor Box used to connect 4 Dispensers = Bobrick P/N: 319308
- Single AC Adapter = Bobrick P/N: 824-222
- Four Wire Assemblies = Bobrick P/N: 319309

This kit is supplied with a cULus, CE, GS listed, double insulated AC to DC switching power supply. The power supply is equipped with a low voltage outlet cord terminated with a barrel connector for attachment with a mating jack located in the Multi Adapter Distributor Box. The power supply is equipped with an interchangeable standard 2 pole NEMA plug intended for direct mounting into a standard 120V NEMA duplex outlet. For warranty purposes, it is required that the power converter must plug into an AC outlet that is not accessible to the dispenser user. If not available, consult a licensed electrical contractor. The power supply output is to be routed through the mounting wall as a low voltage, energy limited circuit, similar to a thermostat wire, with no requirement for electrical box or attachment strain relief. Use only the power supply supplied with this unit. Any substitution could damage the unit and will void any warranty.

1. Locate or provide an AC outlet that is not accessible to the dispenser user.
 - A. See a qualified, licensed electrician for the proper installation of a standard 120V NEMA duplex outlet, if one is required, and for the proper routing of the 824-201 AC to DC Switching Power Supply. The installation must comply with local building code.
2. Plug the barrel plug end of the AC to DC switch power supply (see Fig. A) into the AC to DC power jack in the B-824/B-828 Automatic Soap Dispenser. Use this step for all additional dispensers (see Fig. B). Extra cord should be stored in a location inaccessible to the dispenser user.
3. Plug the power source end into the Multi Adapter Distributor Box (see Fig C).

Note: Only 4 B-824/828 can be plugged into the Power Distributor Box.

4. Plug power supply into an outlet (see Fig. D), and allow unit to cycle through. (LED lights will flash through the Light Pipe (see Fig. E) of each unit as it cycles through and primes each dispenser).
5. If not fully primed, prime dispenser by placing hand under spout repeatedly until fully primed. Hand must be removed from activation area to reset each time.

For Trouble shooting dispenser refer to installation instruction sheet Form No. 824-191.

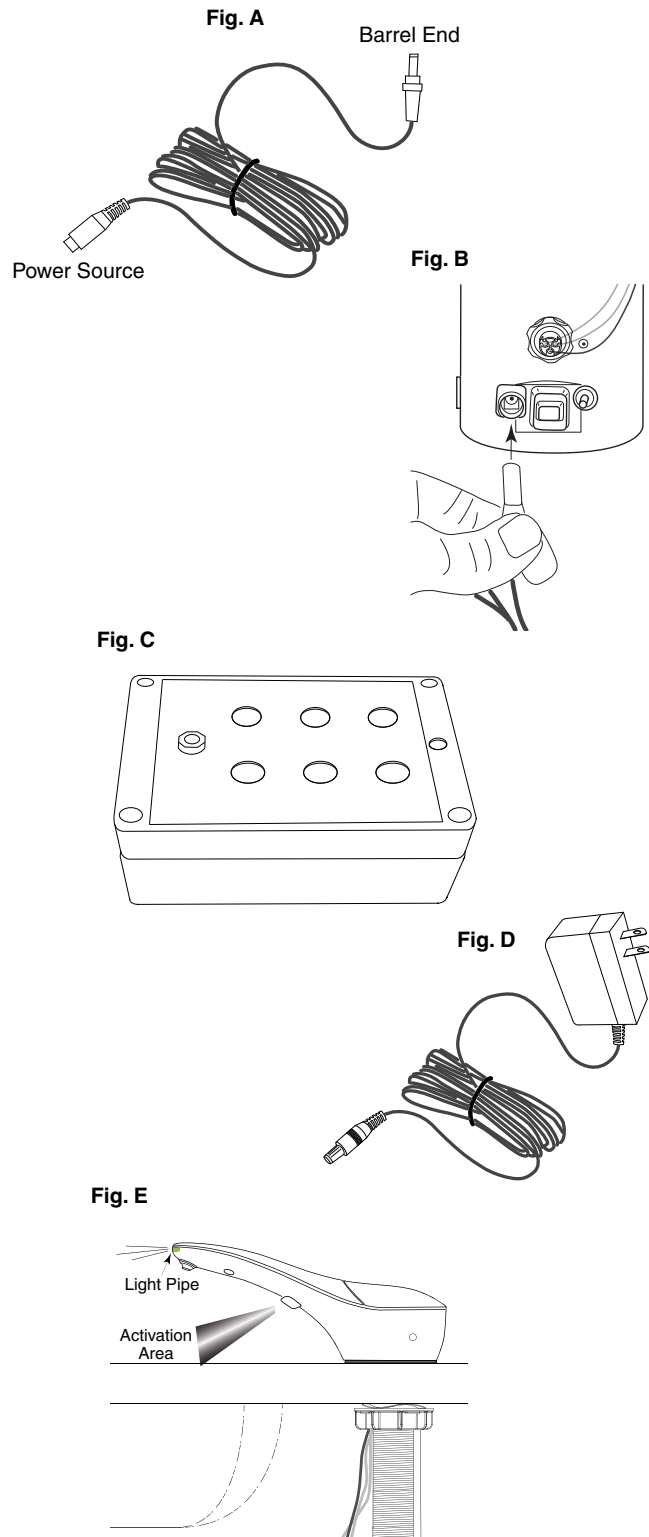

In the U.S.A.: BOBRICK WASHROOM EQUIPMENT, INC.

Los Angeles: 6901 Tujunga Ave., North Hollywood, CA 91605-6213; Tel: (818) 982-9600, FAX: (818) 503-1102
New York: 200 Commerce Drive, Clifton Park, NY 12065-1350; Tel: (518) 877-7444, FAX: (518) 877-5029, or e-mail: customer.service@bobrick.com

In Canada: BOBRICK WASHROOM EQUIPMENT COMPANY

45 Rolark Drive, Scarborough, Ontario M1R 3B1 • Ontario East: Tel: (877) 423-6555 • FAX: (877) 423-8555
• Manitoba West: Tel: (877) 423-6444 • FAX: (877) 423-8444