

For maximum requirements: S 7000 *Prefino*

There are tasks that only specialists can handle. Furnishing changing rooms, for example. Where the crucial bit of extra space, functionality, and design is needed - that's where Prefino comes into play:

- **Extra-large locker capacity**
for more storage space
- **Special interior fittings**
for practical and orderly lockers
- **Absolutely sanitary**
thanks to smooth interior walls and bases
- **Optimum use of space and interior design**
thanks to versatility and reconfiguration options
- **Double-walled design**
for interior lighting, safe and clean online locking systems, and much more



Steel



Stainless steel



HPL decor

The durable system body made of steel (alternatively stainless steel or aluminum) is the ideal basis for creative door variants in different materials.

For additional details, please see the Prefino product series brochure.





Real-wood veneer



Glass with printed motifs



HPL with vectogram



Prefino offers countless customization options.

We look forward to your project-specific inquiry and will gladly provide you with an offer tailored to your specific needs.





Have a seat!

Depending on a building's design, a variety of different sub-frames can be utilized with locker systems. Prefino is flexible - and therefore well equipped for any challenge.

In addition to the classic foot and base designs, integrated bench solutions are becoming more and more commonplace. Be it overhanging benches on an existing base, benches built in front with shorter doors, or benches with storage boxes underneath: Prefino is the best choice for an ideal outcome.



All of the sub-frames shown here are very easy to clean, in part thanks to the clear-cut corner solutions. For you, this means extraordinarily sanitary conditions and simple, fast, and therefore cost-effective cleaning. Furthermore, the option with storage boxes underneath offers additional space that has generally gone unused - a true added benefit for visitors.

We look forward to your project-specific inquiry.



Bench with storage box underneath:

The bench surface serves as a lid that can be opened only by the user of the locker. It ensures that bags, helmets, and other items can be stored comfortably and removed easily.



A clean solution.

In areas with high hygiene requirements (such as the food industry), locker systems have to meet special demands. The connection to existing ventilation and extraction systems also requires a professional solution.



Benches in front with HPL seat: This version as well as the variant with storage box underneath can also be retrofitted on request.

Swing-over bench
This bench serves as the transition from the contaminated area to the clean space. Street shoes remain on the contaminated side.

In addition, this also requires suitable supplementary products, such as swing-over benches, over which employees move from the "contaminated area" to the "clean area". C+P offers the perfect range for these furnishing tasks.



The highlight: S 7000 *Prefino*



Sanitary and easy to clean

Thanks to the smooth interior walls and bases, "dirty corners" are a concept unknown to Prefino. The double walls offer a safe installation space for interior lighting, online locking systems, ventilation and extraction systems, and much more - a novelty on the market!

Smooth interior walls - and endless possibilities behind them



The Prefino ventilation concept

Drying and ventilation play a major role in locker design. In Prefino lockers, the optimized air flow design allows clothing to dry much faster than in conventional lockers. It offers options ranging from the effective self-drying concept (SVL) all the way to forced ventilation with an integrated dryer. (See illustration)

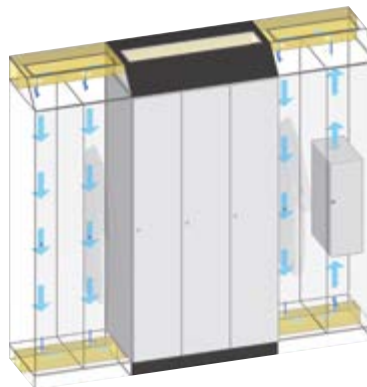

The allrounder for special furnishing needs.



Steel doors: Double-walled and insulated, 19 mm thick, offers unlimited color coating options.

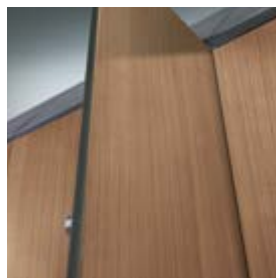

HPL doors: Made of high-pressure laminate, 13 mm thick and available in a variety of appealing decors.



Glass doors: Made of colored, enameled safety glass, 8 mm thick, for a particularly classy design.



Labeling and orientation: Customized numbering and pictograms (monitors integrated in the glass or mirror panel on request).

Lockers



Lockers 466



Double-tier lockers 468



Assembled box lockers 470



Z lockers Business Class 478



Glass shelves: Made of safety glass, 8 mm thick, as an elegant and stylish solution for the interior.



Monitor and LED lighting: Can be integrated behind the attractive mirror panels.



All common mechanical and electronic locking systems can be integrated in Prefino: From turning bolt latches to coin-operated locks to electronic online locking systems with central display, which also provides information about the free and occupied lockers.



S 7000 Prefino

The S 7000 Prefino series offers more:

- Durable sheet steel construction with multi-functional modular system and overlapping doors
- **Spacious body height of 1850 mm (1950 mm incl. feet or base)**
- **Body and steel doors electrolytically zinc-plated as a standard**
- Fronts made of steel, optionally HPL with wood decor or enameled glass for an even more attractive appearance
- Double-walled design for high stability
- **Smooth interior walls - sanitary and easy to clean**
- Compartment sizes can also be retrofitted later
- Door opening limiter 90° and doorstop silencers for outstanding closing characteristics as standard fittings
- Cylinder lock with 2 keys
- **Novel slanted roof (optional)**
- Perforated hat shelf for improved ventilation
- Coat rail with 4 double coat hooks and different positioning options for optimum adaptation to user behavior
- Wide variety of interior fitting solutions for any requirement
- Sub-frame alternatively with feet, base, spacious storage box, or bench
- Optimum ventilation, alternatively through SVL (self-ventilation), FVL (forced ventilation), or FVLD concept (forced ventilation with dryer)
- Glass doors always supplied in disassembled state for safe transportation

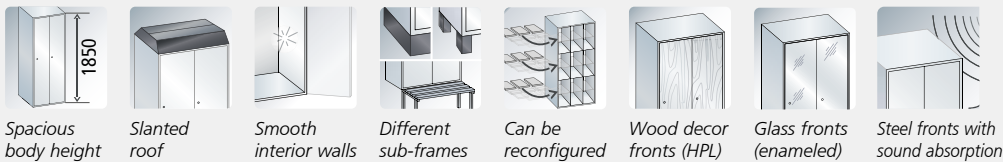

A Lockers with full-length doors

on feet 100 mm high, depth 500 mm.
Clear opening dimensions per door:
1810 x 262/362 x 478 mm (H x W x D),
each compartment with hat shelf, coat rail,
and 4 hooks

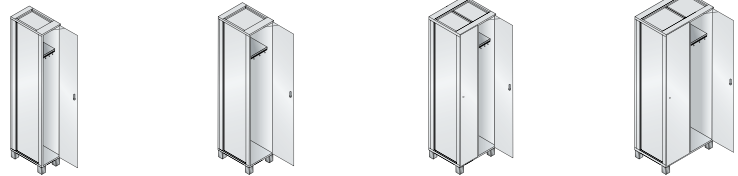

1. Dimensions and door material



	300	400	600	800
Width	300	400	600	800
Height	1950	1950	1950	1950
Compartments	1 x 300	1 x 400	2 x 300	2 x 400
CSC	2	3	4	5
Order no.	46110-10	46110-12	46110-20	46110-22
Price €	359,-	419,-	579,-	699,-

+ HPL decor doors



Thickness 13 mm				
+ Order no.	+ 46110-730	+ 46112-730	+ 46120-730	+ 46122-730
+ Addtl. charge €	+ 60,-	+ 80,-	+ 120,-	+ 160,-

+ Glass doors



Thickness 8 mm				
+ Order no.	+ 46110-750	+ 46112-750	+ 46120-750	+ 46122-750
+ Addtl. charge €	+ 140,-	+ 170,-	+ 280,-	+ 340,-

2. Body color (see end of catalog for color overview)

Please choose **587**

3. Door color (door decor for HPL design + glass colors if applicable)

Please choose **587**

+ Accessories

Additional fittings, locks **480** - **487**

+ Steel side panel

Can be used for right or left side.

B **One panel required for each visible outer surface per row of lockers.**

Height	1850
Depth	500
CSC	1
+ Order no.	+ 4600-716
+ Addtl. charge €	+ 59,-

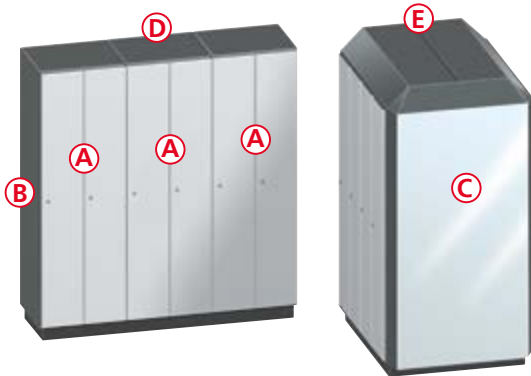

- A** Locker rows or individual lockers..... 466
- B** Side panel.....from 466
- C** Mirror panel..... 482
- D** Smooth top plate..... 480
- E** Slanted roof..... 480

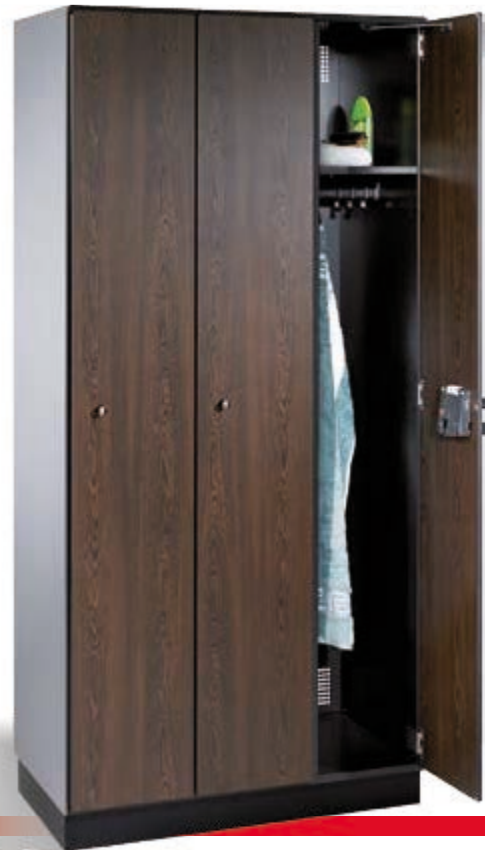

Order no. 46120-30
 + 46130-730 (HPL decor doors in wenge)
 + 4600-716 (steel side panel)

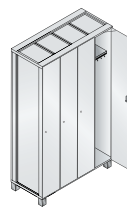
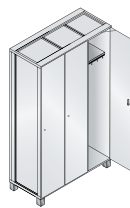

1.	900	1200	1200
	1950	1950	1950
	3 x 300	3 x 400	4 x 300
	5	6	6
	46110-30	46110-32	46110-40
	849,-	1.029,-	1.099,-
+	+ 46130-730 + 180,-	+ 46132-730 + 240,-	+ 46140-730 + 240,-
+	+ 46130-750 + 420,-	+ 46132-750 + 510,-	+ 46140-750 + 560,-



+ **Base**
 instead of feet,
 steel design,
 100 mm high,
 approx. 60 mm
 height adjustment

Color (standard)	Black gray RAL 7021
Locker height	1950
Order no.	...2-..
+ Addtl. charge €	+ 20,-



Order no. 46110-20
 + 4600-716 (steel side panel)



Order no. 46210-20
+ 4600-716 (steel side panel)

A Lockers with 2 tiers

on feet 100 mm high, depth 500 mm.
Clear opening dimensions per door:
895 x 262/362 x 478 mm (H x W x D),
each compartment with coat rail and 4 hooks



1. Dimensions and door material



	300	400	600
Width	300	400	600
Height	1950	1950	1950
Compartments	1 x 300	1 x 400	2 x 300
CSC	2	3	4
Order no.	46210-10	46210-12	46210-20
Price €	439,-	489,-	739,-

+ HPL decor doors



Thickness 13 mm			
+ Order no.	+ 46110-730	+ 46112-730	+ 46120-730
+ Addtl. charge €	+ 60,-	+ 80,-	+ 120,-

+ Glass doors



Thickness 8 mm			
+ Order no.	+ 46210-750	+ 46212-750	+ 46220-750
+ Addtl. charge €	+ 180,-	+ 220,-	+ 360,-

2. Body color (see end of catalog for color overview)

Please choose **587**

3. Door color (door decor for HPL design + glass colors if applicable)

Please choose **587**

+ Steel side panel

Can be used for right or left side.
B One panel required for each visible outer surface per row of lockers.

Height	1850
Depth	500
CSC	1
+ Order no.	+ 4600-716
+ Addtl. charge €	+ 59,-

+ Accessories

Additional fittings, locks **480** - **487**

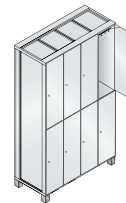
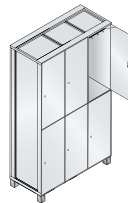
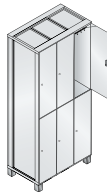

1.

800	900	1200	1200
1950	1950	1950	1950
2 x 400	3 x 300	3 x 400	4 x 300
5	5	6	6
46210-22	46210-30	46210-32	46210-40
839,-	1.049,-	1.189,-	1.379,-

+

+ 46122-730 + 160,-	+ 46130-730 + 180,-	+ 46132-730 + 240,-	+ 46140-730 + 240,-
------------------------	------------------------	------------------------	------------------------

+

+ 46222-750 + 440,-	+ 46230-750 + 540,-	+ 46232-750 + 660,-	+ 46240-750 + 720,-
------------------------	------------------------	------------------------	------------------------

+

Base
instead of feet,
steel design,
100 mm high,
approx. 60 mm
height adjustment

Color (standard)	Black gray RAL 7021
Locker height	1950
Order no.	...2-..
+ Addtl. charge €	+ 20,-



S 7000 Prefino

A Lockers with 3 tiers

on feet 100 mm high, depth 500 mm.
Clear opening dimensions per door:
590 x 262/362 x 478 mm (H x W x D),
without interior fittings

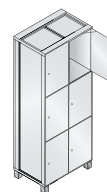
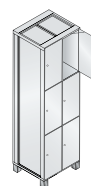

1. Dimensions and door material

	Width	300	400	600	800
	Height	1950	1950	1950	1950
	Compartments	1 x 300	1 x 400	2 x 300	2 x 400
	CSC	3	4	5	6
	Order no.	46310-10	46310-12	46310-20	46310-22
	Price €	479,-	539,-	839,-	939,-

	Thickness 13 mm				
	+ Order no.	+ 46110-730	+ 46112-730	+ 46120-730	+ 46122-730
	+ Addtl. charge €	+ 60,-	+ 80,-	+ 120,-	+ 160,-

	Thickness 8 mm				
	+ Order no.	+ 46310-750	+ 46312-750	+ 46320-750	+ 46322-750
	+ Addtl. charge €	+ 280,-	+ 330,-	+ 560,-	+ 660,-



Order no. 46310-22
+ 4600-716 (steel side panel)

Assembled box lockers

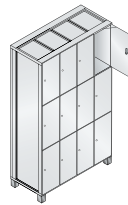
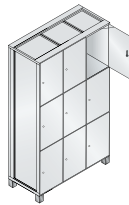

1.	900	1200	1200
	1950	1950	1950
	3 x 300	3 x 400	4 x 300
	6	7	8
	46310-30	46310-32	46310-40
	1.199,-	1.349,-	1.549,-

+	+ 46130-730	+ 46132-730	+ 46140-730
	+ 180,-	+ 240,-	+ 240,-

+	+ 46330-750	+ 46332-750	+ 46340-750
	+ 840,-	+ 990,-	+ 1.120,-

2. Body color (see end of catalog for color overview)
 Please choose **587**

3. Door color (door decor for HPL design + glass colors if applicable)
 Please choose **587**

+ **Steel side panel**
 Can be used for right or left side.
(B) One panel required for each visible outer surface per row of lockers.

Height	1850
Depth	500
CSC	1
+ Order no.	+ 4600-716
+ Addtl. charge €	+ 59,-

+ **Base**
 instead of feet, steel design, 100 mm high, approx. 60 mm height adjustment

Color (standard)	Black gray RAL 7021
Locker height	1950
Order no.	...2.-.
+ Addtl. charge €	+ 20,-



+ **Accessories**
 Additional fittings, locks **480** - **487**



Order no. 46320-30
 + 46130-730 (HPL decor doors in wenge)
 + 4600-716 (steel side panel)



A Lockers with 4 tiers

on feet 100 mm high, depth 500 mm.
Clear opening dimensions per door:
437 x 262/362 x 478 mm (H x W x D),
without interior fittings



1. Dimensions and door material

Steel doors



	300	400	600	800
Width	300	400	600	800
Height	1950	1950	1950	1950
Compartments	1 x 300	1 x 400	2 x 300	2 x 400
CSC	3	4	5	6
Order no.	46410-10	46410-12	46410-20	46410-22
Price €	549,-	599,-	969,-	1.069,-

+ HPL decor doors



Thickness 13 mm				
+ Order no.	+ 46110-730	+ 46112-730	+ 46120-730	+ 46122-730
+ Addtl. charge €	+ 60,-	+ 80,-	+ 120,-	+ 160,-

+ Glass doors



Thickness 8 mm				
+ Order no.	+ 46410-750	+ 46412-750	+ 46420-750	+ 46422-750
+ Addtl. charge €	+ 390,-	+ 450,-	+ 780,-	+ 900,-

2. Body color (see end of catalog for color overview)

Please choose 587



3. Door color (door decor for HPL design + glass colors if applicable)

Please choose 587





Order no. 46420-40
+ 4600-716 (steel side panel)

+ Steel side panel
Can be used for right or left side.
(B) One panel required for each visible outer surface per row of lockers.

Height	1850
Depth	500
CSC	1
+ Order no.	+ 4600-716
+ Addtl. charge €	+ 59,-



1.	900	1200	1200
	1950	1950	1950
	3 x 300	3 x 400	4 x 300
	6	7	8
	46410-30	46410-32	46410-40
	1.399,-	1.549,-	1.799,-

+ Base
instead of feet,
steel design,
100 mm high,
approx. 60 mm height
adjustment



+ 46130-730	+ 46132-730	+ 46140-730
+ 180,-	+ 240,-	+ 240,-
+ 46430-750	+ 46432-750	+ 46440-750
+ 1.170,-	+ 1.350,-	+ 1.560,-

Color (standard)	Black gray RAL 7021
Locker height	1950
Order no.	...2.-..
+ Addtl. charge €	+ 20,-

+ Accessories
Additional fittings, locks **480** | - **487**

S 7000 Prefino



A Lockers with 5 tiers

on feet 100 mm high, depth 500 mm.
Clear opening dimensions per door:
346 x 262/362 x 478 mm (H x W x D),
without interior fittings

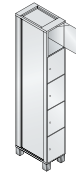

1. Dimensions and door material

Steel doors



	300	400
Width	300	400
Height	1950	1950
Compartments	1 x 300	1 x 400
CSC	4	5
Order no.	46510-10	46510-12
Price €	619,-	669,-

+ HPL decor doors



Thickness 13 mm		
+ Order no.	+ 46110-730	+ 46112-730
+ Addtl. charge €	+ 60,-	+ 80,-

+ Glass doors



Thickness 8 mm		
+ Order no.	+ 46510-750	+ 46512-750
+ Addtl. charge €	+ 490,-	+ 550,-

2. Body color (see end of catalog for color overview)

Please choose **587**

3. Door color (door decor for HPL design + glass colors if applicable)

Please choose **587**

+ Steel side panel

Can be used for right or left side.
B One panel required for each visible outer surface per row of lockers.

Height	1850
Depth	500
CSC	1
+ Order no.	+ 4600-716
+ Addtl. charge €	+ 59,-

+ Base

instead of feet, steel design, 100 mm high, approx. 60 mm height adjustment

Color (standard)	Black gray RAL 7021
Locker height	1950
Order no.	...2-..
+ Addtl. charge €	+ 20,-



+ Accessories

Additional fittings, locks **480** | **487**



Assembled box lockers

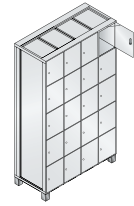
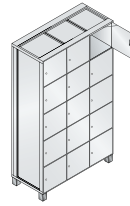
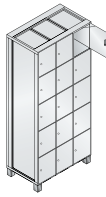
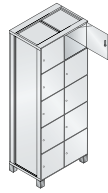

1.	600	800	900	1200	1200
	1950	1950	1950	1950	1950
	2 x 300	2 x 400	3 x 300	3 x 400	4 x 300
	6	7	8	9	10
	46510-20	46510-22	46510-30	46510-32	46510-40
	1.099,-	1.199,-	1.599,-	1.749,-	2.079,-

+	+ 46120-730 + 120,-	+ 46122-730 + 160,-	+ 46130-730 + 180,-	+ 46132-730 + 240,-	+ 46140-730 + 240,-
---	------------------------	------------------------	------------------------	------------------------	------------------------

+	+ 46520-750 + 980,-	+ 46522-750 + 1.100,-	+ 46530-750 + 1.470,-	+ 46532-750 + 1.650,-	+ 46540-750 + 1.960,-
---	------------------------	--------------------------	--------------------------	--------------------------	--------------------------



A Lockers with 6 tiers

on feet 100 mm high, depth 500 mm.
Clear opening dimensions per door:
285 x 262/362 x 478 mm (H x W x D),
without interior fittings

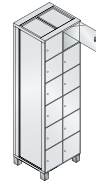

1. Dimensions and door material

	300	400	600
Width	300	400	600
Height	1950	1950	1950
Compartments	1 x 300	1 x 400	2 x 300
Steel doors	CSC	4	5
	Order no.	46610-10	46610-12
	Price €	669,-	729,-



HPL decor doors	Thickness 13 mm		
	+ Order no.	+ 46110-730	+ 46112-730
	+ Addtl. charge €	+ 60,-	+ 80,-



Glass doors	Thickness 8 mm		
	+ Order no.	+ 46610-750	+ 46612-750
	+ Addtl. charge €	+ 590,-	+ 650,-

2. Body color (see end of catalog for color overview)

Please choose **587**

3. Door color (door decor for HPL design + glass colors if applicable)

Please choose **587**

+ Steel side panel

Can be used for right or left side.



One panel required for each visible outer surface per row of lockers.

Height	1850
Depth	500
CSC	1
+ Order no.	+ 4600-716
+ Addtl. charge €	+ 59,-

+ Accessories

Additional fittings, locks **480** - **487**



Order no. 46620-32
+ 46132-730 (HPL decor doors in wenge)
+ 4600-716 (steel side panel)

Assembled box lockers

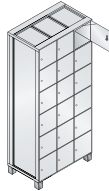
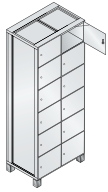

1.	800	900	1200	1200
	1950	1950	1950	1950
	2 x 400	3 x 300	3 x 400	4 x 300
	7	8	9	10
	46610-22	46610-30	46610-32	46610-40
	1.339,-	1.769,-	1.949,-	2.279,-
+	+ 46122-730 + 160,-	+ 46130-730 + 180,-	+ 46132-730 + 240,-	+ 46140-730 + 240,-
+	+ 46622-750 + 1.300,-	+ 46630-750 + 1.770,-	+ 46632-750 + 1.950,-	+ 46640-750 + 2.360,-

+ **Base**
 instead of feet,
 steel design,
 100 mm high, approx.
 60 mm height adjustment

Color (standard)	Black gray RAL 7021
Locker height	1950
Order no.	..2.-..
+ Addtl. charge €	+ 20,-



Business Class Z lockers offer you more:

- Optimum use of the interior space for 2 users, with low floor-space requirements
- **Lots of storage space!** Large, bulky bags or helmets, long garments, shoes, and small objects all have their place
- Excellent view of locker content thanks to the **functional interior arrangement**
- **No troublesome door projections** like in conventional Z lockers, meaning there is no risk of injury
- **All users have compartments of exactly the same size**
- **Uniform appearance** with a harmonious mix of small and large doors that fits well into any room



4 x order no. 46226-20
as a block with a vectogram

A Z lockers Business Class

on **base** 100 mm high, depth 500 mm, for use in areas that only offer enough space for a double-tier locker but still require long garments to be hung. Every compartment with coat rail and 3 double coat hooks

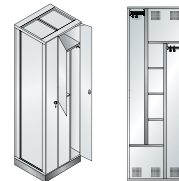

1. Dimensions and door material



Width	600
Height	1950
Compartments	1 x 600
CSC	4
Order no.	46226-20
Price €	1.199,-

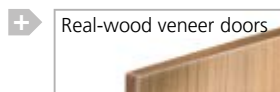

Real-wood veneer doors	Thickness 19 mm	
	+ Order no.	+ 46220-790
	+ Addtl. charge €	+ 350,-

2. Body color (see end of catalog for color overview)

Please choose **587**

3. Door decor

Please choose **587**



4 x order no. 46226-20
as a block with equipment panels
and slanted roof

+ Accessories

Additional fittings, locks **480** - **487**



Security compartment
instead of the hat shelf
(available as an option)



Vectogram on an HPL door
(available as an option)



Electronic online locking
systems (available as an
option)



Double coat hooks





(F) Side cover panel for slanted roof

to be mounted individually or back to back

for locker depth	500	
Order no.	4604-710L	4604-710R
+ Addtl. charge €	+ 15,-	+ 15,-

Pairs of doors closing in the middle*

Doors with joint lock, addtl. charge **per pair**

for locker width	600	800
Order no.2-..2-..
+ Addtl. charge €	+ 36,-	+ 36,-



(D) Smooth top plate

made of steel, for locker depth 500 mm

for locker width	300	400	600	800	900	1200	1200
for compartments	1 x 300	1 x 400	2 x 300	2 x 400	3 x 300	3 x 400	4 x 300
Order no.	4600-760	4600-761	4600-762	4600-763	4600-764	4600-765	4600-765
+ Addtl. charge €	+ 18,-	+ 20,-	+ 28,-	+ 32,-	+ 38,-	+ 45,-	+ 45,-



(E) Slanted roof

empty, for coverage of equipment installed on-site, for locker depth 500 mm

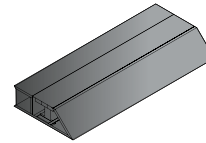

for locker width	300	400	600	800	900	1200	1200
for compartments	1 x 300	1 x 400	2 x 300	2 x 400	3 x 300	3 x 400	4 x 300
Order no.	4604-10	4604-12	4604-20	4604-22	4604-30	4604-32	4604-32
+ Addtl. charge €	+ 65,-	+ 71,-	+ 75,-	+ 82,-	+ 86,-	+ 97,-	+ 97,-



(E) Slanted roof with lighting

with integrated furniture light incl. illuminant, color white, for locker depth 500 mm

We also offer project-specific additional variants, for example with colored light for spa areas or prepared for existing ventilation systems.

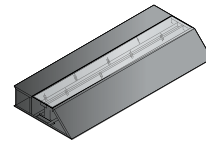

for locker width	300	400	600	800	900	1200	1200
for compartments	1 x 300	1 x 400	2 x 300	2 x 400	3 x 300	3 x 400	4 x 300
Order no.	-	-	4604-200	4604-220	4604-300	4604-320	4604-320
+ Addtl. charge €	-	-	+ 295,-	+ 305,-	+ 330,-	+ 360,-	+ 360,-

Slope tops

without locker: rear approx. 230 mm high (= nothing can remain on the locker!)

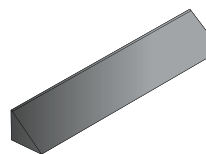

for locker width	300	400	600	800	900	1200	1200
for compartments	1 x 300	1 x 400	2 x 300	2 x 400	3 x 300	3 x 400	4 x 300
Order no.	4631-70	4641-70	4632-70	4642-70	4633-70	4643-70	4643-70
+ Addtl. charge €	+ 70,-	+ 75,-	+ 80,-	+ 85,-	+ 90,-	+ 95,-	+ 95,-

The novel Prefino slanted roof solution:
Offers lots of space for functional ideas - from housing ventilation and supply lines to completely integrated indirect lighting.

Design variants and accessories

Additional fittings in the locker

Shoe tray
made of plastic, removable, with bottom spacers



Order no.
Price €

4500-707
11,50

Coat hanger with laundry net
the classic option for pools, spas, and similar facilities



8501-04251
18,-

Coat hanger with multi-function hooks
as an alternative to the net, for example for areas with special hygiene requirements



8501-04
13,-

Towel hanger
movable, for easier drying of large towels



4500-760
10,-

Additional fittings on the locker door

Mirror
for steel and HPL doors, to be mounted by the customer, 300 x 180 mm (H x W)



for compartment width
Order no.
Price €

400
4500-762
12,-

Towel holder
for HPL doors hinged on right

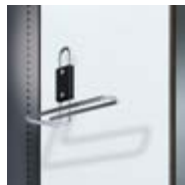

300
4600-7703R
13,-

Towel and shower gel holder
for HPL doors hinged on right

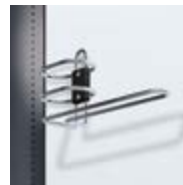

400
4600-7713R
21,-

Flip-flop and shoe holder
for HPL doors



300/400
4600-7733
21,-

Glass shelf

made of safety glass, 8 mm thick, addtl. charge per shelf



for compartment width
Order no.
Price €

300	400
4600-580	4600-582
55,-	65,-

Foldable deposit area

made of steel, addtl. charge per compartment



Order no.
Price €

4600-775
79,-



Mirror panels

Prefino offers a range of different end face plates to enhance both the function and the appearance of the ends of locker rows, which often go unused.

The panels with integrated mirrors with or without deposit areas, with sockets or lighting, allow for customized options for this space.

They can either be attached to lockers or simply to the walls of a room.



C End face plate
to be attached to the side of the locker row, **for locker depths of 500 mm**
For additional mirror panel options, please submit a project-specific inquiry.

Locker configuration
single-row

Locker configuration
back to back



Width	500	1000
Height	1850	1850



Mirror full surface

Order no. **4010-185050**
Price € 429,-

4010-185100
639,-



Mirror full surface and 2 LED lights behind the mirror

Order no. -
Price € -

4011-185100
1.640,-



Mirror full surface, deposit area with 2 sockets, 2 LED lights behind the mirror

Order no. -
Price € -

4012-185100
2.140,-

Face plates

We recommend taking the measurements after the lockers have been delivered and assembled.

Front face plates

made of steel, coated in color of front, **steel panels in fixed dimensions***

Gap width	110	145	180	215	250
Front roof panels (FR)					
Order no.	4604-01-011	4604-01-014	4604-01-018	4604-01-021	4604-01-025
Price €	42,-	44,-	46,-	49,-	51,-
Front panels (FP)					
Order no.	4001-185011	4001-185014	4001-185018	4001-185021	4001-185025
Price €	89,-	94,-	98,-	105,-	109,-
Front base panel (FB)					
Order no.	4001-010011	4001-010014	4001-010018	4001-010021	4001-010025
Price €	28,-	29,-	30,-	31,-	32,-

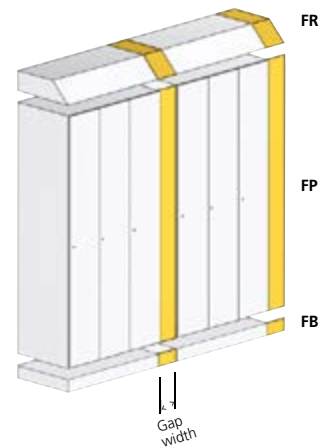

Interior corner face plates

made of steel, coated in color of front, **steel panels for 90° interior corner, not adjustable (fixed dimensions)**

Gap width	55	110
Distance to wall	539	578
Interior corner roof panels (IR)		
Order no.	4604-02-005	4604-02-011
Price €	82,-	84,-
Interior corner panels (IP)		
Order no.	4004-185005	4004-185011
Price €	86,-	89,-
Interior corner base panels (IB)		
Order no.	4604-010005	4604-010011
Price €	30,-	31,-

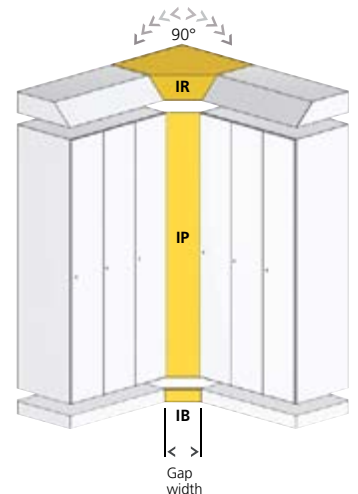

Exterior corner face plates

made of steel, coated in color of front, **steel panels for 90° exterior corner, not adjustable (fixed dimensions)**

for locker depth	500
Exterior corner roof panels (ER)	
Order no.	4604-03-040
Price €	86,-
Exterior corner panels (EP)	
Order no.	4003-185040
Price €	125,-
Exterior corner base panels (EB)	
Order no.	4604-010040
Price €	49,-

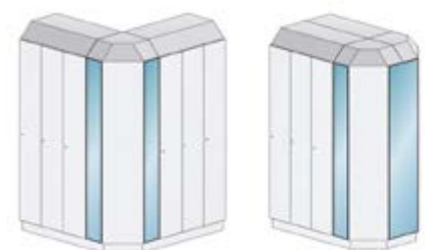
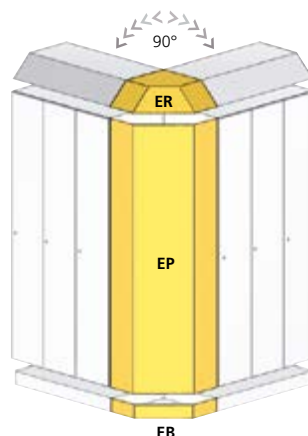

* For adjustable panels for connection to wall, please submit a project-specific inquiry.